



MaestroShield®

Protection Like No Other

MaestroScreens

Adjustable Track

(recessed or surface mounted)

with

**5.5" Rounded Hood
Installation Manual**

MaestroShield® Headquarters: Florida, USA 33916

Office: +1.239.596.8883 • Fax: +1.239.596.8823 • Toll Free 866.549.0269

Email: sales@maestrosshield.com

www.MaestroShield.com

Copyright © 2014 MaestroShield. All Rights Reserved

Content

- Recommended Tool List
- Recommended Fasteners
- **First part:** Surface Mount Installation
- **Second part:** Trapped Installation

The installation of the MaestroScreen System is a result of the measurements taken at the beginning of the project. For the seasoned installer the entire process can be completed in 45 minutes.

The screen is a series of 90° degree angles. The more level, flush, and plum the side tracks and hood, the easier the installation.

Recommended Tool List



- Drill



- 7/64" drill bit, 1/8" drill bit (for motors with manual override only), 1/4" drill bit, 1/2" drill bit, 5/8" drill bit



- 1/4" hex driver, 5/16 hex driver



- Level (suggested length: 4ft)



- Tape measure



- #2 Phillips screwdriver and paperclip



- Razor Knife

Recommended Fasteners (not supplied)

| PER SCREEN | | | |
|------------|------------|------------------|------------------|
| STRUCTURE | SCREW TYPE | HOOD | SIDE TRACKS |
| Stucco | Tapcon | (8) 5/16x 1-1/4" | (8) 5/16x 1-1/4" |
| Wood | Lag Bolt | (8) 5/16x2-1/4" | (8) 5/16x 1-1/4" |
| Aluminium | Tek Screws | (8) #10x3/4" | (8) #10x3/4" |

MaestroScreens

This installation manual is divided into *two sections*. Please follow instructions for proper installation:

First part: Surface Mount Installation

Second part: Trapped Installation

MaestroScreens

MaestroScreens



First part: Surface Mount Installation Manual

MaestroScreens

Installation | Hood

Step 1. Remove front of Hood

Remove 1/4" tek screw from each end of hood. Hinge front cover towards you, then lift out.



IF MOTOR TUBE ASSEMBLY IS INSTALLED

Remove retaining pin from motor tube. Grasp tube and push toward spring idlers side until motor shaft clears cradle then remove motor tube assembly and set aside.

Step 2:

1. Determine where hole for power cord is to be run (recommended areas is shaded in red, use your best judgement to decide). Using 1/2" drill bit, drill through side cap and hood.
2. Insert rubber grommet into drilled hole for finished look (needs to be bought separately).
3. Drill through the hood at the pre-drilled fastener holes in the sidecaps.

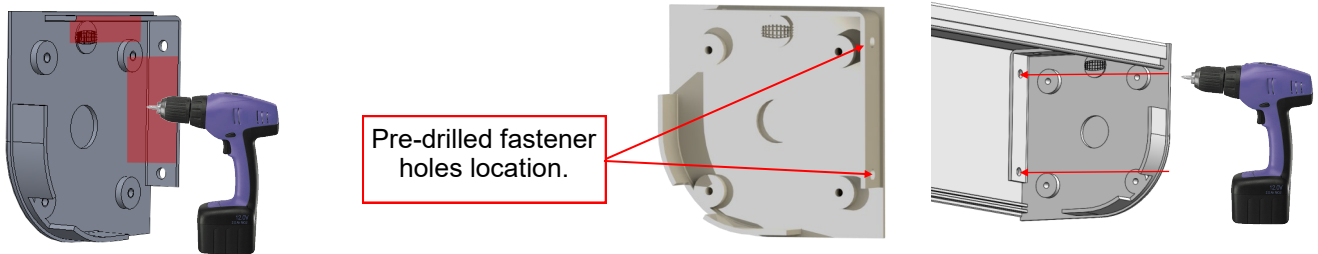

- Step 3.** Hold hood assembly in place. Add 5-1/2" to top of opening and mark. Before fastening hood assembly, check that it is level, and at the correct height. Once level and aligned, anchor top screw ONLY of left and right side cap using pre-drilled holes in side caps.

If bottom bar needs to clear opening, add an additional 3" to opening of measurements (X)

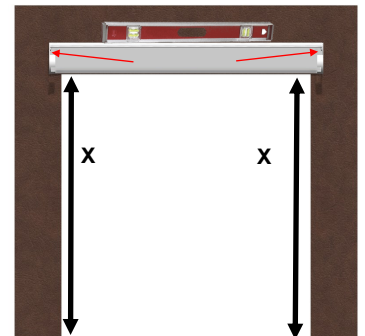

- Step 4.** Fasten bottom anchors of both side caps.

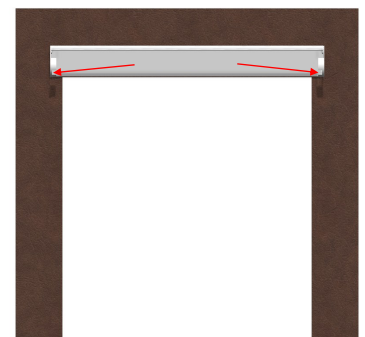

Installation | Motor

Note:
Outer Tubes "must" be centered with equal distances on each side. If not even, adjust accordingly.

Step 5.

Attach motor tube assembly into side cap and hood assembly by:

1. inserting **idler shaft** into mounting plate (held in place by spring mechanism)
2. and then **motor shaft** into motor plate (type of mounting plate depends on the motor but the procedure is the same)

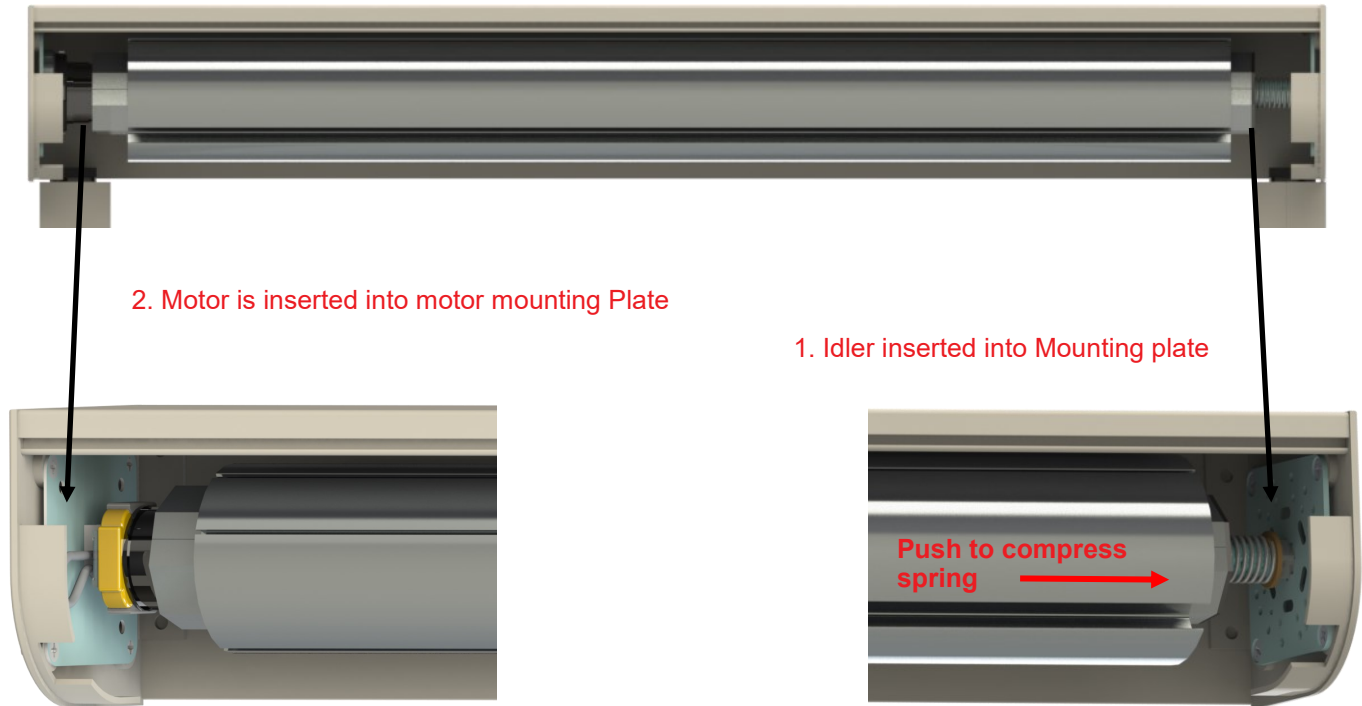

- ## Step 6.
- Feed motor wire through grommet affixed to hole in side cap.

Connect motor to power supply according to motor instructions. A professional electrician should be consulted.

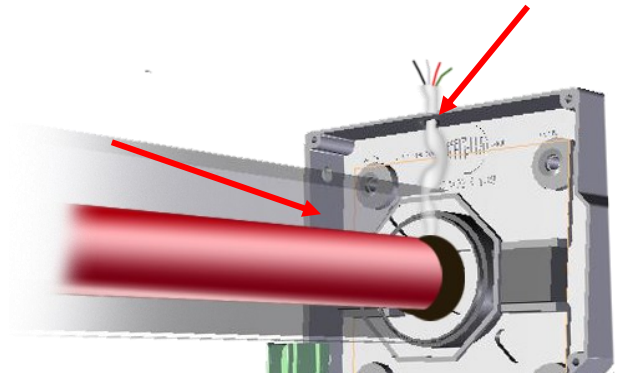

- ## Step 7.
- Program remote to motor using the programming instructions, once synchronized, position the motor tubes keder groove facing towards you shown with the arrow.

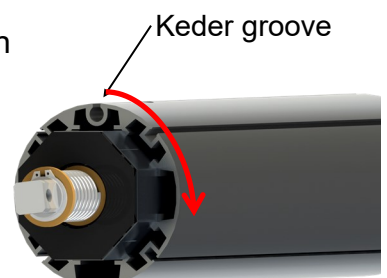

Installation | Important Motor Protection

Motor Protection: All Types

Protecting the Outdoor Electric Motor from Water Damage:

To prevent water from entering the head of the motor, it is highly recommended that a “drip loop” be formed as shown below.

Notice the bottom of the loop is lower than the cord’s entry point to the motor. Rain water gaining access into the roller function could damage the internal components of the motor.

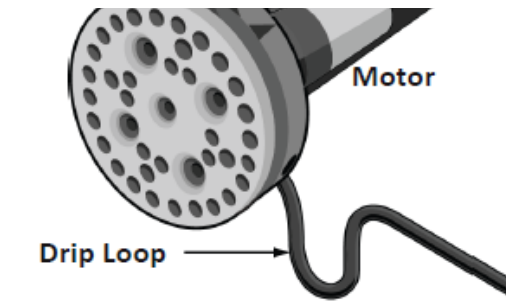

Example Only: Below is Smart Motor with Drip Loop
Drip Loops should be used on all motor types.

IMPORTANT



Installation | Side Tracks

Step 8. Using the measurements x, confirm outer side tracks are correct length. If not cut outer and inner side tracks to accurate length.

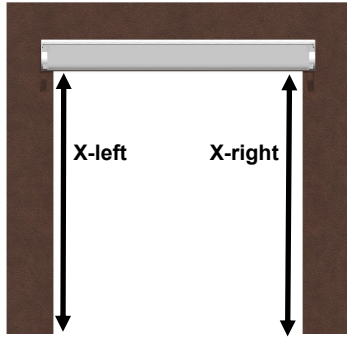

IMPORTANT:
DO NOT cut the side with the entry guide.

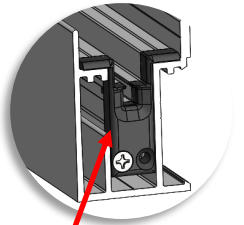

Step 9. Install outer section of the left and right side track under the hood for top and outside measurements. Ensure that hood is level and outside of side cap is flush with outside of side track. **ONLY FASTEN TOP SCREWS.***

Do not insert inner tracks!

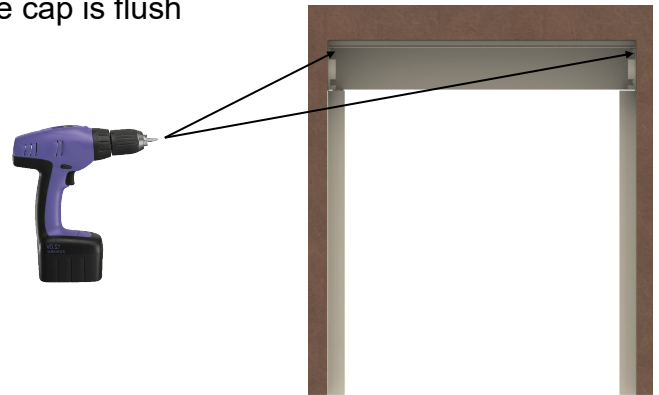

Step 10. Using a level, adjust the left side track until leveled. When leveled, predrill and insert bottom fastener. Insert remaining fasteners.

Repeat for right side.

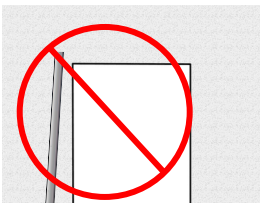
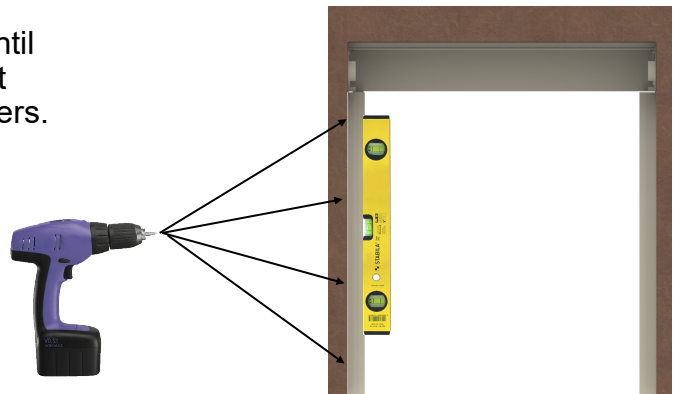

IMPORTANT: Side tracks **MUST BE** installed plumb and flush for proper operation of Screen.

Installation | Screen

Step 11. Take the screen without assembled bottom bar and slide the keder into the slot of the outer motor tube.

Make sure the side of the screen with the extended zipper is facing down.

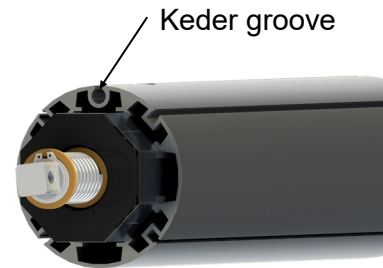

Step 12.

1. Slide the bottom bar onto the bottom of the screen and reattach. **Also insert the weight bars if needed before attaching the end retention in the next step.**
2. Ensure that the zipper loops are facing the front of the bottom bar.

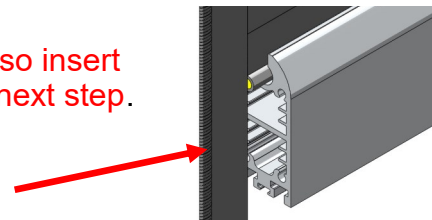

Step 13.

1. Secure the end retention of bottom bar on both sides.
2. Insert zipper into end retention and pull it tight, leaving a gap between the end retention and zipper loops.
3. Insert the three screws while still pulling the zipper
4. Trim **excess** of zipper below the end retentions with scissors.

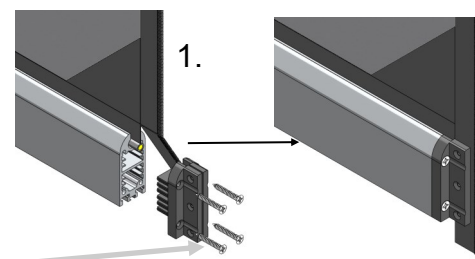

6-32x1, TYF 410 410 Stainless, Phillips Flat Head M/S

IMPORTANT:
DO NOT cut the zipper like the picture below.

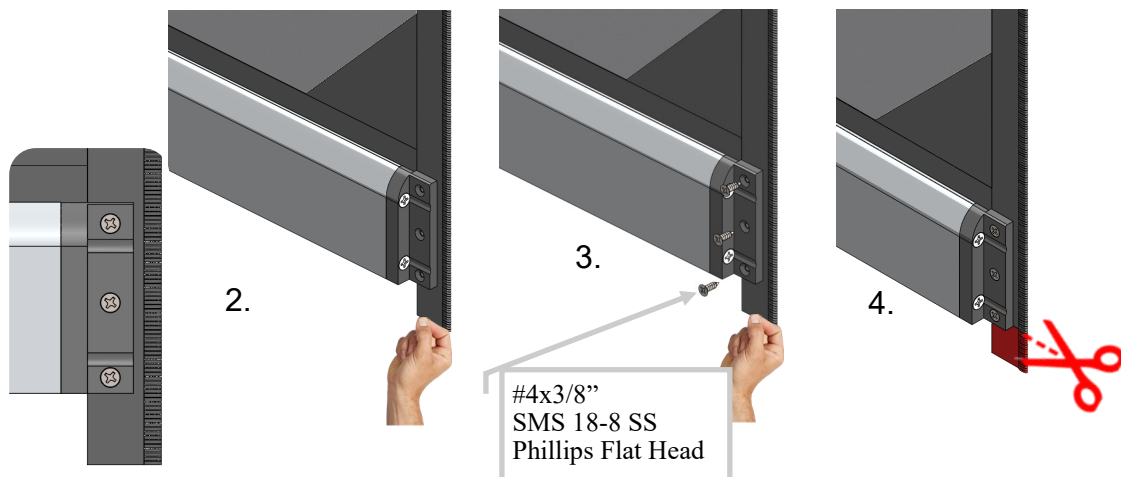

#4x3/8" SMS 18-8 SS Phillips Flat Head

Step 14. Center the screen on the tube and use the remote to carefully roll the screen all the way up.

The screen must be rolled up on the back side of the motor tube as shown.

Welding always faces front of the bottom bar

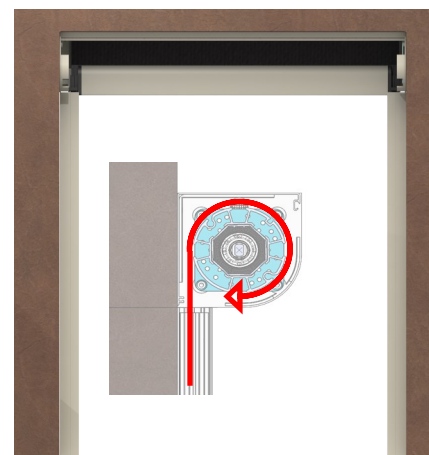
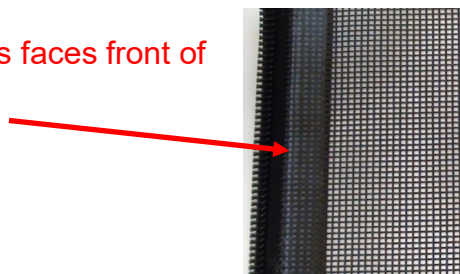

Installation | Side tracks

Step 15.

1. Install inner tracks by tilting and sliding up through the outer track and bottom bar, then insert the bottommost adjustment screw. **Note: Be sure the inner track is mated with the same outer track it was originally packaged with.**
2. While the screen is up – set upper limit, either mechanically or electronically depending on the type of motor. See instruction from the box with the remote.

IMPORTANT: When setting upper limit, the top of the bottom bar should not go over the top of the sidetracks.

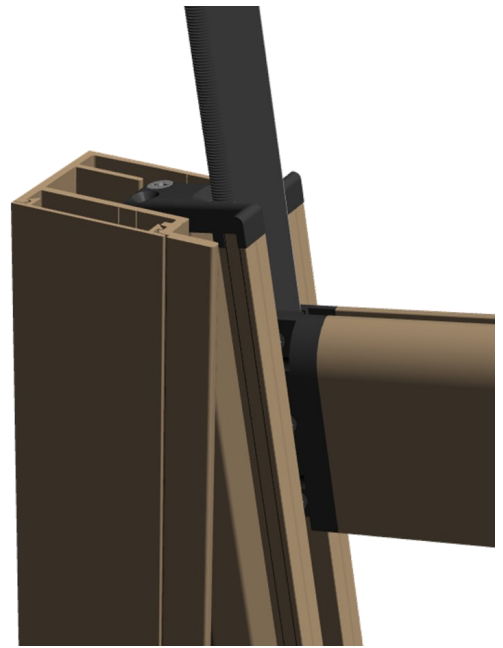

Step 16. Run the screen all the way to the bottom and make sure the zipper does not fall out of the entry guide or track.

Be sure to feed zipper into entry guides evenly to avoid wrinkling fabric or damaging zipper teeth.



Step 17. Insert the rest of the adjustment screws (# 6x1" flat head sheet metal screws) **except the topmost one.** Make sure not to tighten as much as in the third picture below. Allow some slack in the screen for the next step.

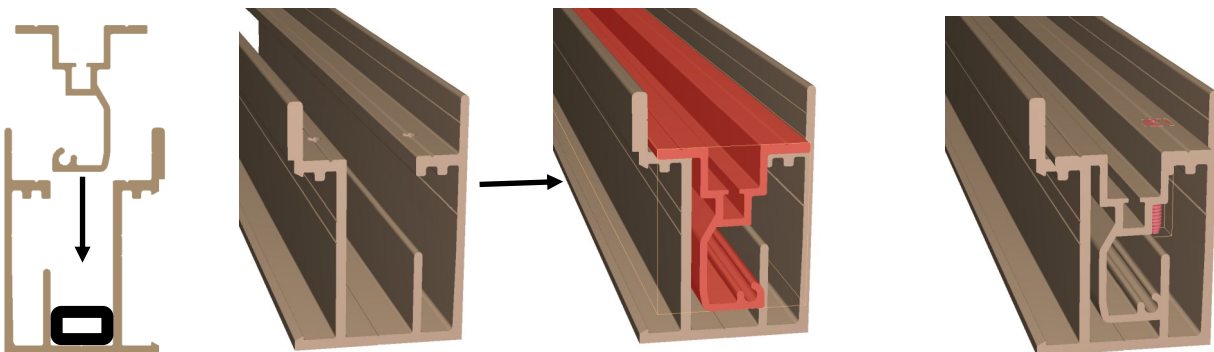

Installation | Screen

Step 18. While the screen is down – **set lower limit.**
See instruction from the box with the remote or motor.



Step 19. Roll the screen up and down. If any screws stick out from the inner track—tighten them slightly until they touch the inner track.

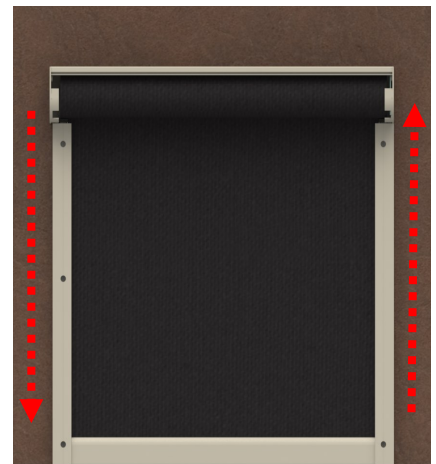

Step 20.

1. Insert the topmost adjustment screw.
2. Test roll-up and roll-down functionality of MaestroScreen Motorized Screen System to ensure that screen is operating smoothly without being obstructed in any way.
3. If screen is not operating smoothly, or gets stuck at some parts, adjust the inner tracks using adjustment screws to relieve or increase tension on screen. Alternatively add more weight to the bottom bar if you install the screen in a windy area.
4. Make sure the limits are set correctly.

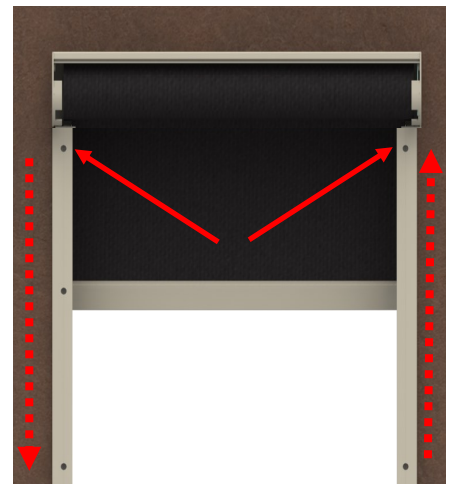

Installation | Covers

Step 21. On front section of each outer side track, snap the cover (marked in red) into the outer track. Cut to correct length if needed.

Note: make sure all previous steps are done before doing this.

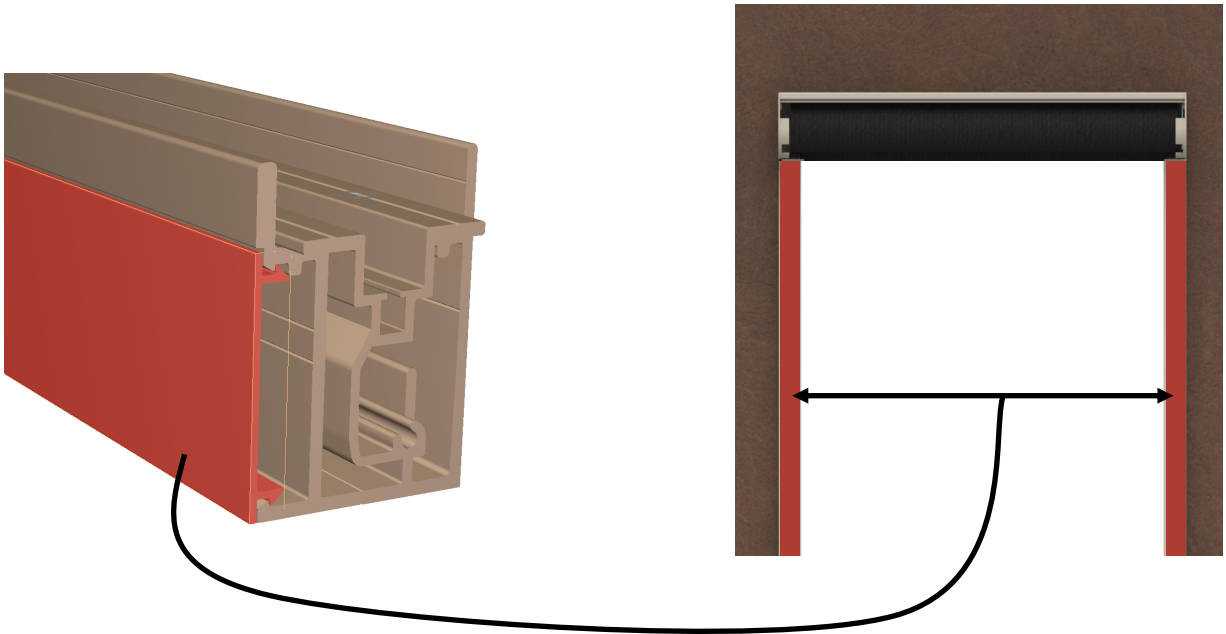

NOTE: If installation has concealing cover a hood face is not necessary!

Step 22. Reattach front hood using #10 3/4" Hex Head self tapping screw into each side of the bottom section of the hood.



Congratulations to a successful install!

MaestroScreens

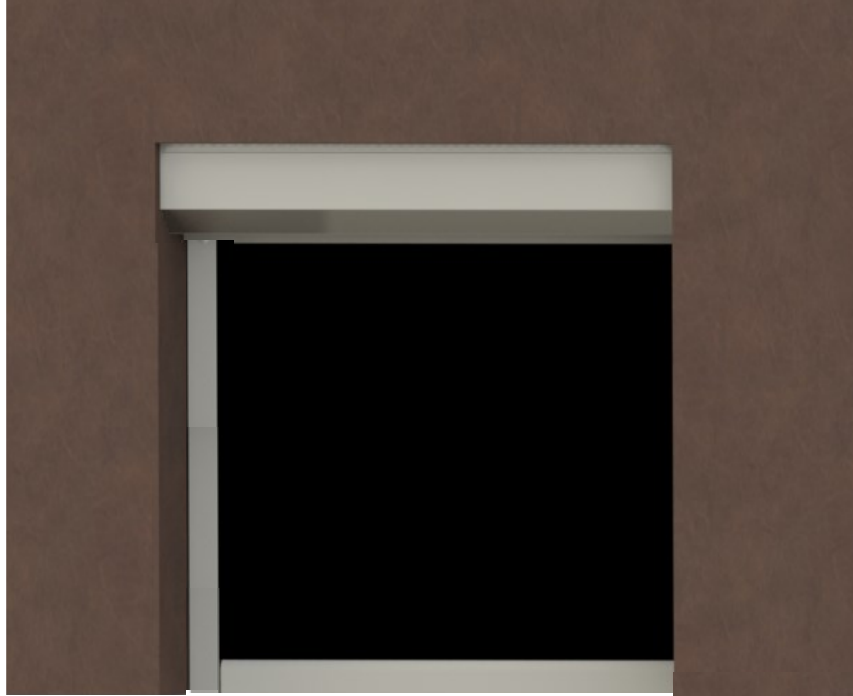

Second part: Trapped Installation Manual

MaestroScreens

Installation | Hood

Step 1. Remove front of Hood

Remove 1/4" tek screw from each end of hood. Hinge front cover towards you, then lift out.



IF MOTOR TUBE ASSEMBLY IS INSTALLED

Remove retaining pin from motor tube. Grasp tube and push toward spring idlers side until motor shaft clears cradle then remove motor tube assembly and set aside.

Step 2:

1. Determine where hole for power cord is to be run (recommended areas is shaded in red, use your best judgement to decide). Using 1/2" drill bit, drill through side cap and hood.
2. Insert rubber grommet into drilled hole for finished look (needs to be bought separately).
3. Drill through the hood at the pre-drilled fastener holes in the sidecaps.

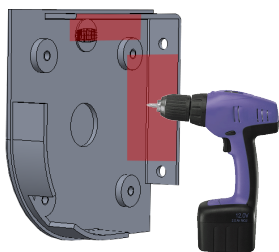

Hole fasteners

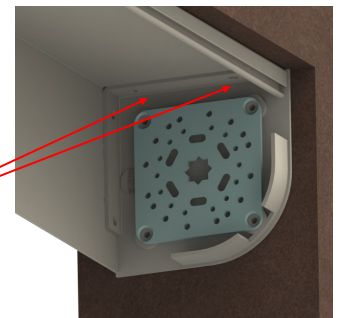

Step 3. Install hood assembly into top of opening in desired position using hole fasteners in side caps.

Level bottom of hood, using a level.
Adjust hood and fasteners if hood is not leveled.

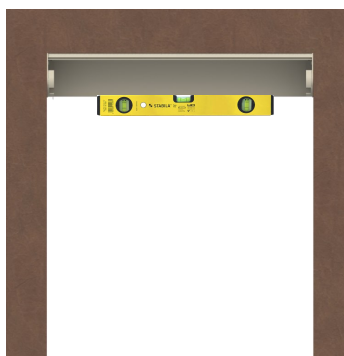

Installation | Motor

Note:
Outer Tubes "must" be centered with equal distances on each side. If not even, adjust accordingly.

Step 4.

Attach motor tube assembly into side cap and hood assembly by:

1. inserting **idler shaft** into mounting plate (held in place by spring mechanism)
2. and then **motor shaft** into motor plate (type of mounting plate depends on the motor but the procedure is the same)

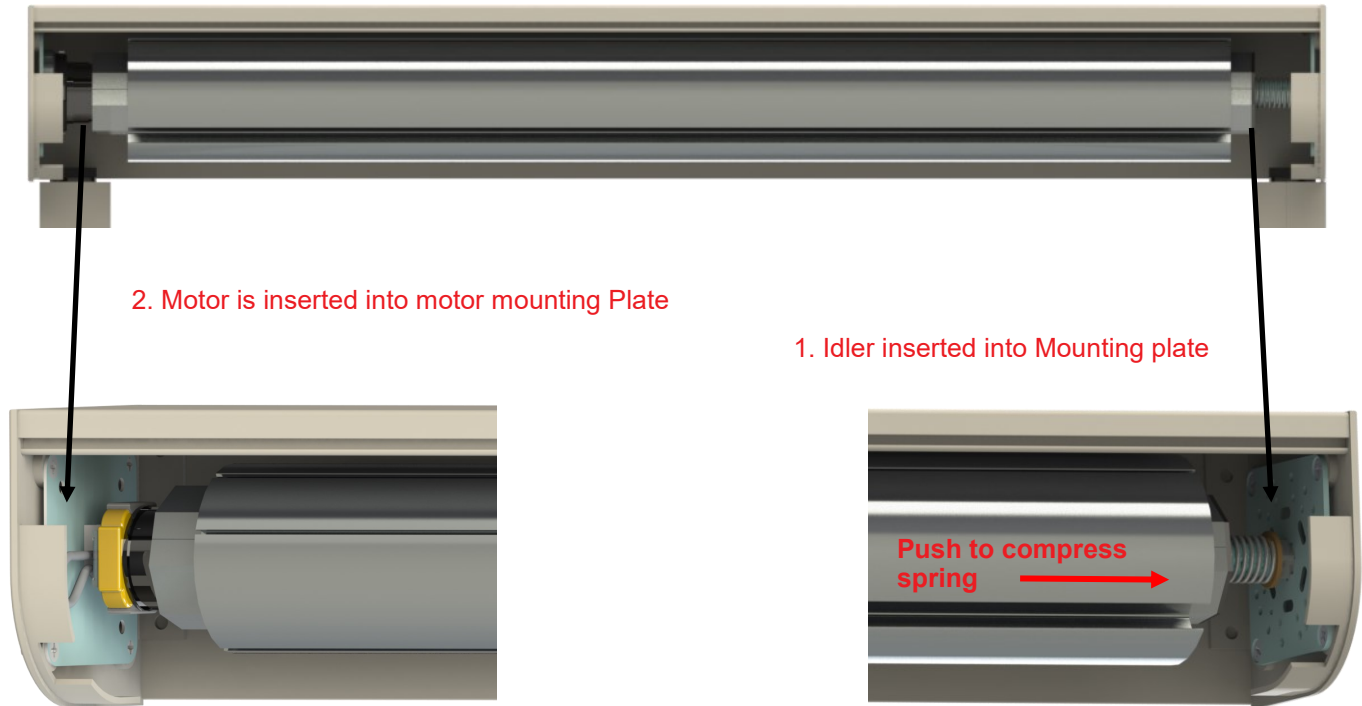

- Step 5.** Feed motor wire through grommet affixed to hole in side cap.

Connect motor to power supply according to motor instructions. A professional electrician should be consulted.

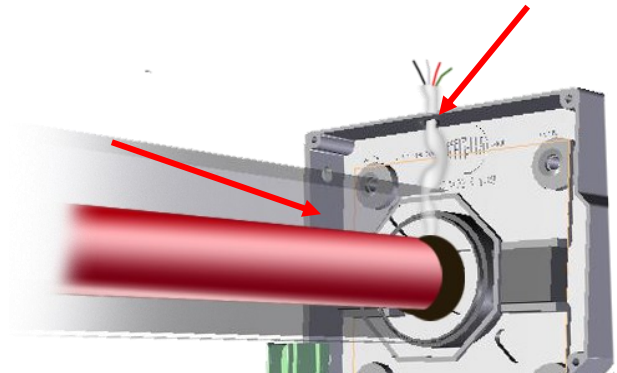

- Step 6.** Program remote to motor using the programming instructions, once synchronized, position the motor tubes keder groove facing towards you shown with the arrow.

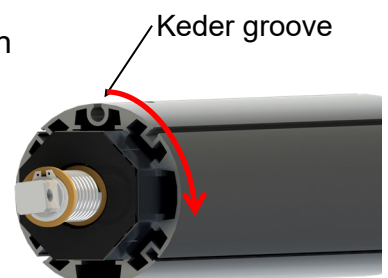

Motor Protection: All Types

Protecting the Outdoor Electric Motor from Water Damage:

To prevent water from entering the head of the motor, it is highly recommended that a “drip loop” be formed as shown below.

Notice the bottom of the loop is lower than the cord’s entry point to the motor. Rain water gaining access into the roller function could damage the internal components of the motor.

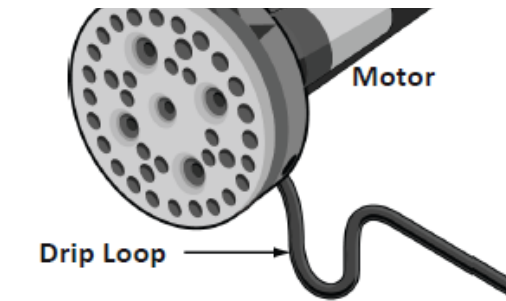

Example Only: Below is Smart Motor with Drip Loop
Drip Loops should be used on all motor types.

IMPORTANT



Installation | Side Tracks

Step 7. Using the measurements below, confirm outer side tracks are correct length. If not cut outer side tracks to accurate length.

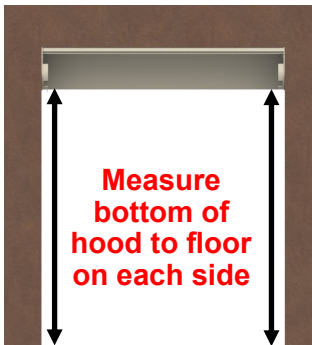

IMPORTANT:
DO NOT cut the side with the entry guide.

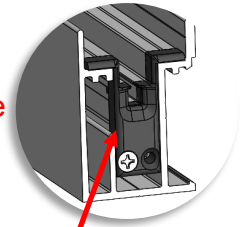

Step 8. Using the back of the hood as a straight edge, align the outer side track to the hood using a level.



Step 9.

Install top fastener on the left and right side tracks.

NOTE: If the sides of the opening are not straight (each side within 0.5"), use a receiving channel to install the outer tracks straight.

1. Install receiving channel to the wall.
2. Fasten outer tracks inside the channels using a level and self tapping sheet metal screws.

Receiving channel

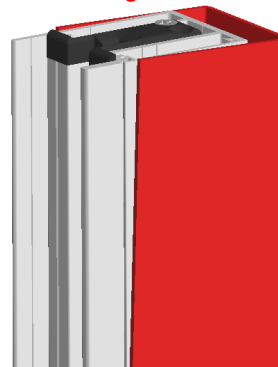

Step 10. Adjust the left side track until leveled. When leveled, insert bottom fastener. Insert remaining fasteners.

Repeat for right side.

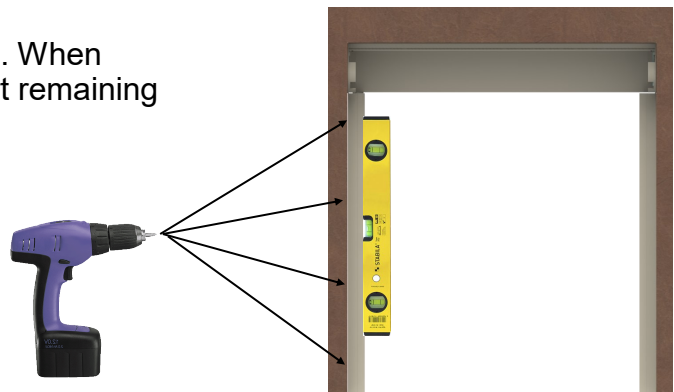

Installation | Screen

Step 11. Take the screen without assembled bottom bar and slide the keder into the slot of the outer motor tube.

Make sure the side of the screen with the extended zipper is facing down.

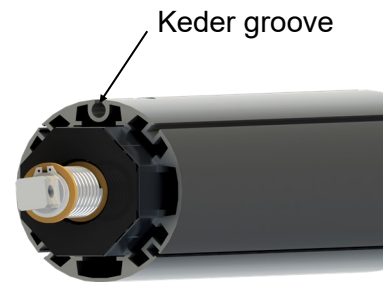

Step 12.

1. Slide the bottom bar onto the bottom of the screen and reattach. Also insert the weight bars if needed before attaching the end retention in the next step.
2. Ensure that the zipper loops are facing the front of the bottom bar.

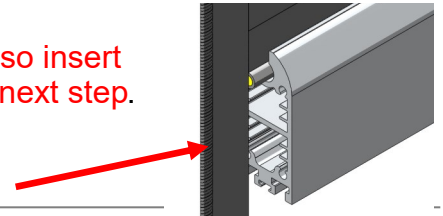

Step 13.

1. Secure the end retention of bottom bar on both sides.
2. Insert zipper into end retention and pull it tight, leaving a gap between the end retention and zipper loops.
3. Insert the three screws while still pulling the zipper.
4. Trim excess of zipper below the end retentions with scissors.

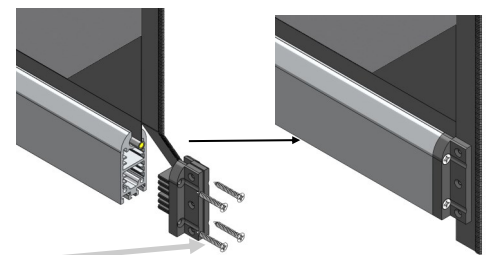

6-32x1, TYF 410 410 Stainless, Phillips Flat Head M/S

IMPORTANT:
DO NOT cut the zipper like the picture below.

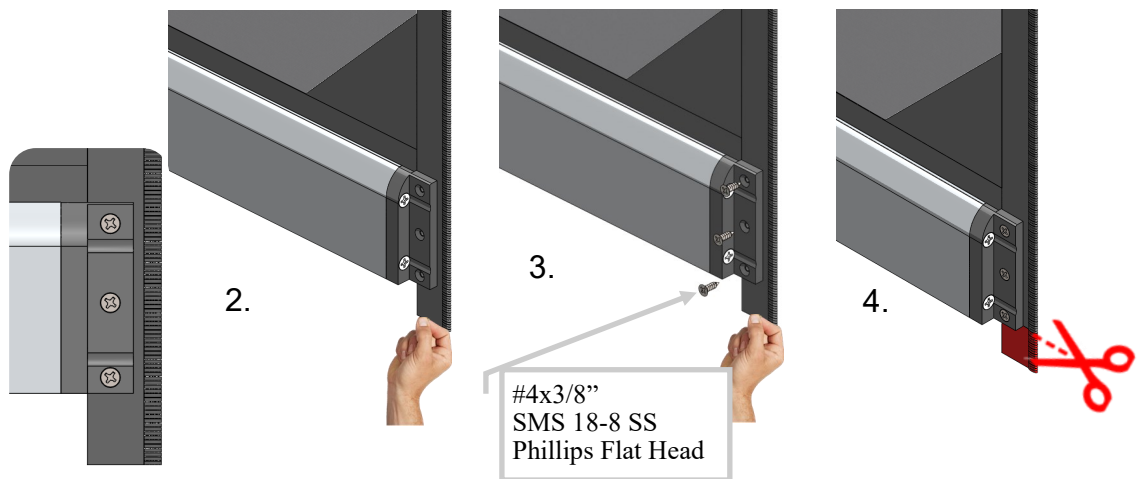
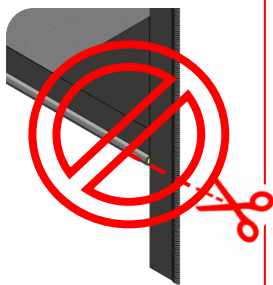

#4x3/8\" SMS 18-8 SS Phillips Flat Head

Step 14. Center the screen on the tube and use the remote to carefully roll the screen all the way up.

The screen must be rolled up on the back side of the motor tube as shown.

Welding always faces front of the bottom bar

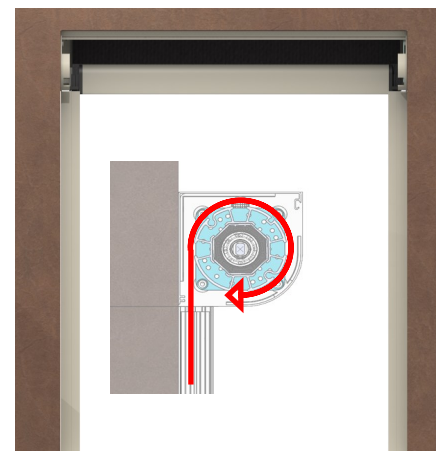
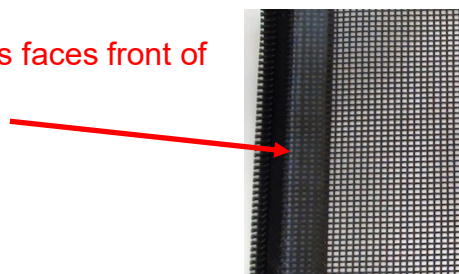

Installation | Side Tracks

Step 15.

1. Install inner tracks by tilting and sliding up through the outer track and bottom bar, then insert the bottommost adjustment screw. **Note: Be sure the inner track is mated with the same outer track it was originally packaged with and the screen is at the top position.**

IMPORTANT: Make sure that the zipper entered the inner track through the entry guide correctly.

1. While the screen is up – set upper limit for smart motors electronically. See instruction from the box with the remote.

IMPORTANT: When setting upper limit, the top of the bottom bar should not go over the top of the sidetracks.

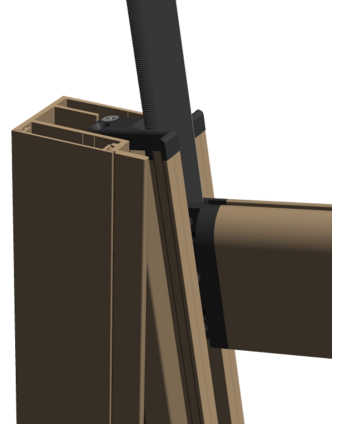
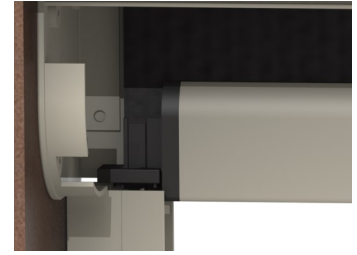

-
- ## Step 16.
- Run the screen all the way to the bottom and make sure the zipper does not fall out of the entry guide or track on each side. Set the lower limit according to motor instructions.

Be sure to feed zipper into entry guides evenly to avoid wrinkling fabric or damaging zipper teeth.



-
- ## Step 17.
- Insert the rest of the adjustment screws (# 6x1" flat head sheet metal screws) **except the topmost one**. Make sure not to tighten as much as in the third picture below. Allow some slack in the screen for the next step.

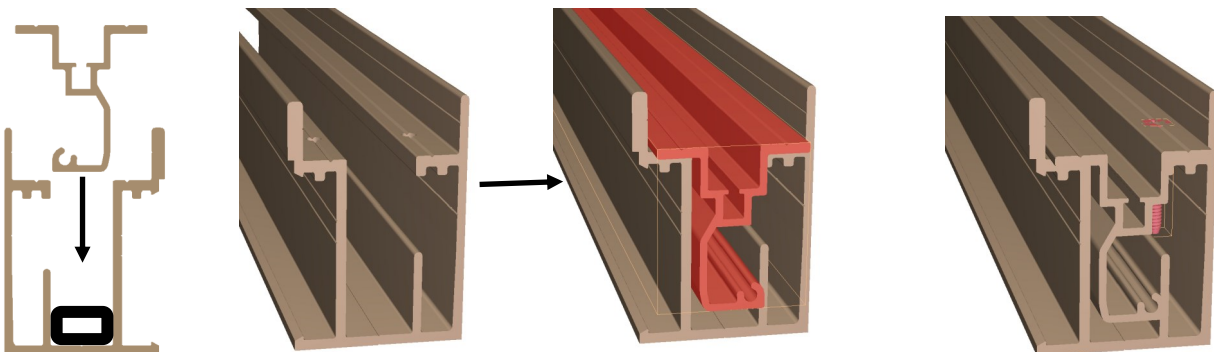

Step 18.

1. Test roll-up and roll-down functionality of MaestroScreen Motorized Screen System to ensure that screen is operating smoothly without being obstructed in any way.
2. If screen is not operating smoothly, or gets stuck at some parts, adjust the inner tracks using adjustment screws to relieve or increase tension on screen. Alternatively add more weight to the bottom bar if you install the screen in a windy area.
3. Make sure the limits are set correctly.

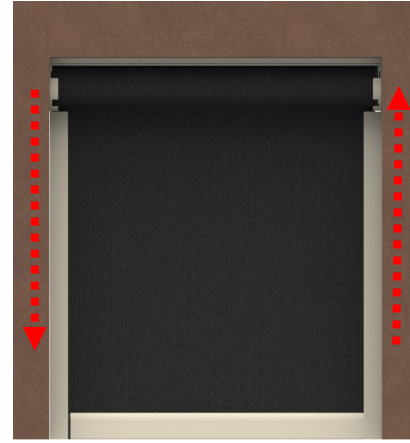

Step 19.

On front section of each outer side track, snap the cover (marked in red) into the outer track as mentioned in step 5.

Cut to correct length if needed.

Note: make sure all previous steps are done before doing this.

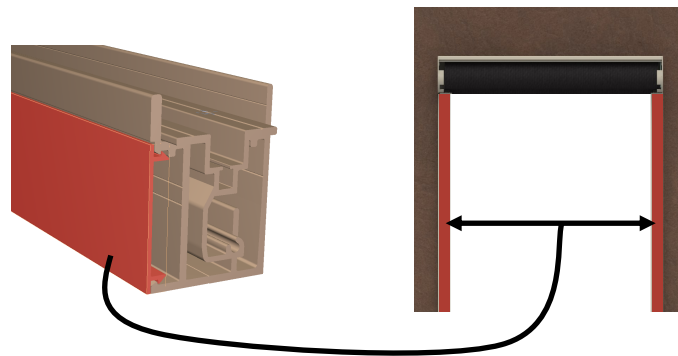

NOTE: If installation has concealing cover a hood face is not necessary!

- Step 20.** Reattach front hood using #10 3/4" Hex Head self tapping screw into each side of the bottom section of the hood.



Congratulations to a successful install!

MaestroScreens Common Problems and Solutions:

| | Fail – Phenomena | Failure Causes | Solutions Failure Recovery |
|---|---|---|--|
| 1 | Bottom bar will not lower completely | <ul style="list-style-type: none"> A. Tracks may not be parallel B. Tracks may have a twist C. Track may have a dent in the slot that the zipper sides in D. Wind will cause the bottom bar to stop while lowering E. Tracks may be adjusted too far in or out F. Adjustment screw securing inner track may be sticking out. G. There may be obstruction inside the track. | <ul style="list-style-type: none"> A. Remove and reinstall inner track making sure measurements are correct and track is being installed exactly parallel. B. Apply shim behind track reduce twist C. Review track for dents D. Continue to lower after wind has stopped |
| 2 | Screen does not travel down tracks smoothly | <ul style="list-style-type: none"> A. Tracks may not be parallel B. Tracks may have a twist C. Track may have a dent in the slot that the zipper sides in D. Wind will cause the bottom bar to stop while lowering E. Tracks may be adjusted too far in or out F. Adjustment screw securing inner track may be sticking out. G. There may be obstruction inside the track. | <ul style="list-style-type: none"> A. Remove and reinstall inner track making sure measurements are correct and track is being installed exactly parallel. B. Apply shim behind track reduce twist C. Review track for dents D. Continue to lower after wind has stopped |
| 3 | Bottom bar is not parallel with hood | <ul style="list-style-type: none"> A. Housing may not be level. | <ul style="list-style-type: none"> A. Install shim tape on out motor tube to level bottom bar. |
| 5 | Screen comes out of track | <ul style="list-style-type: none"> A. Zipper may not be installed in slot B. Upper motor limit may be set to high C. Screen may be offset/not centered on tube. D. Tube may not be leveled. E. Outer tube not centered | <ul style="list-style-type: none"> A. Make sure the zipper is installed correctly in track of the side track. If not, reinstall. B. Check the setting of the upper limit on the motor. The bottom bar should always stay engaged in the track. |